

REV.	Description	REV.	Description
1.0	V0.1首次发行 朱伟 2016/5/13		
2.0	V0.2增加外部接地, 升级料号 朱伟 2016/6/20		

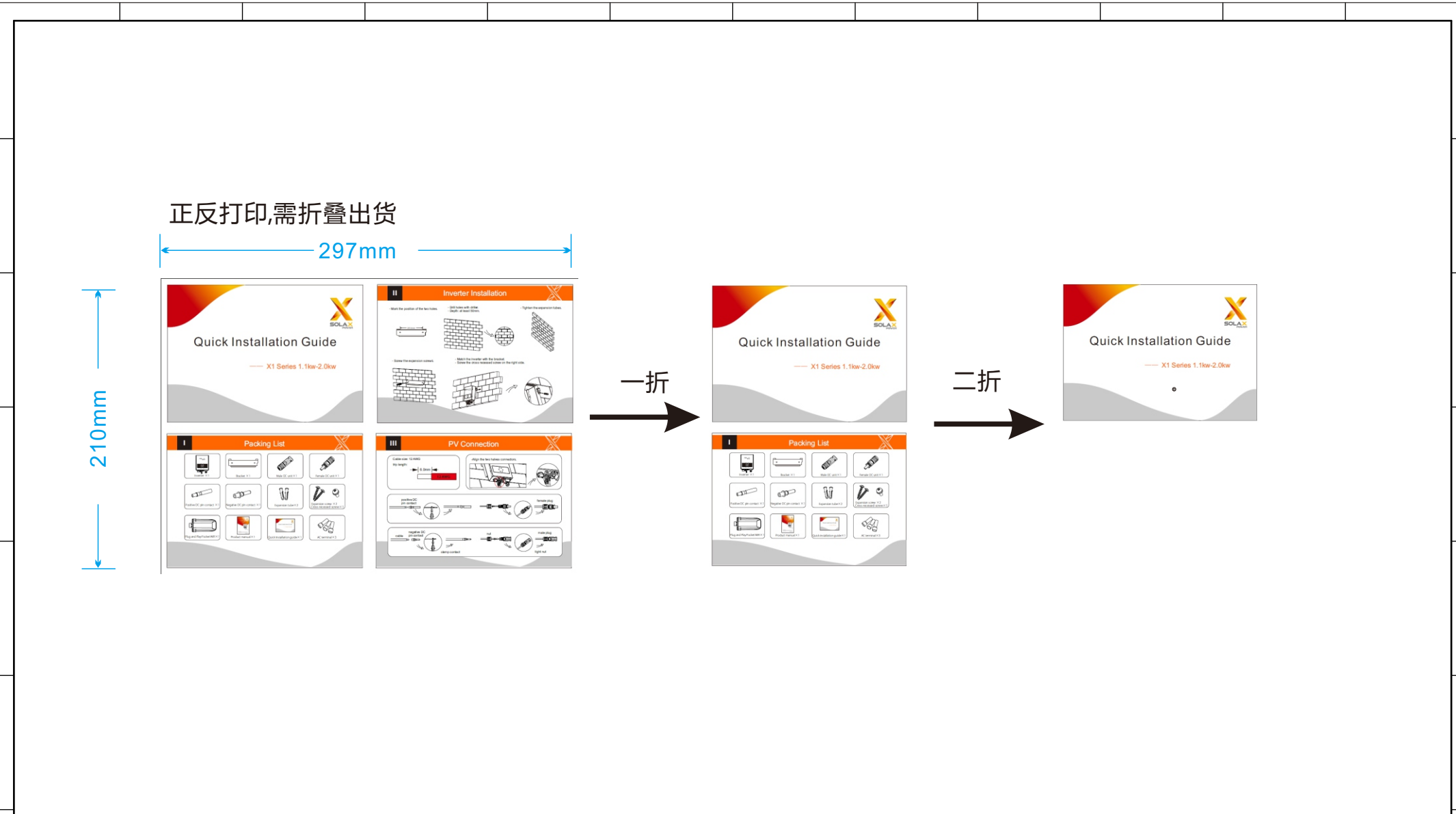

- 技术要求：
- 1.材质为80g双胶纸，所有页彩色打印，正反打印
 - 2.未注尺寸公差按 +- 1.5mm
 - 3.图面、字体印刷清晰、无毛边、不起边、油墨不脱落
 - 4.字体颜色为PANTONE Black C，无边框，底色为白色
 - 5.符合RoHS要求

描述	X1-Mini系列 快速安装指南（英文）		
料号	612.00118.01		
单位	mm	页次	

浙江艾罗电源有限公司
SolaX Power Co.,Ltd.

描述	X1-Mini系列 快速安装指南（英文）	设计	朱伟 2016/6/20
		审核	朱娴红 2016/6/20
材料	双胶纸	核准	朱娴红 2016/6/20
料号	612.00118.01	浙江艾罗电源有限公司	
单位	mm 页次		



Quick Installation Guide

X1 Series 1.1kw-2.0kw

II

Inverter Installation

- Mark the position of the two holes.

- Drill holes with driller.
- Depth: at least 50mm.

- Tighten the expansion tubes.

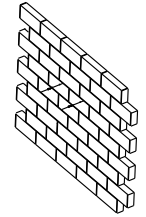
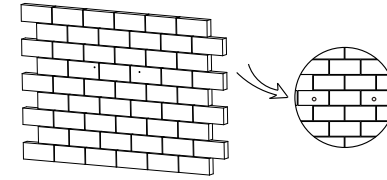
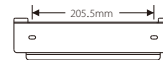

- Screw the expansion screws.

- Match the inverter with the bracket.
- Screw the cross recessed screw on the right side.

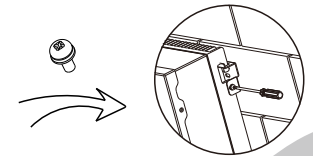
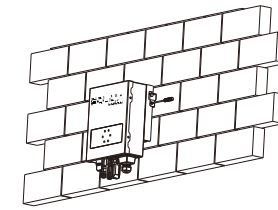
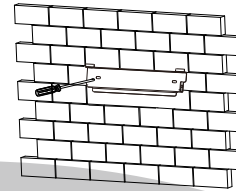

I

Packing List

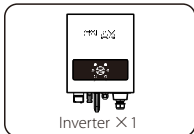

Inverter X 1

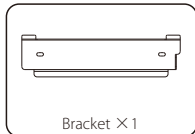

Bracket X 1

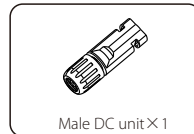

Male DC unit X 1

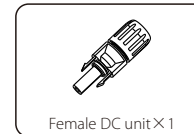

Female DC unit X 1

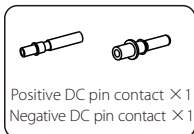

Positive DC pin contact X 1
Negative DC pin contact X 1

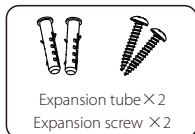

Expansion tube X 2
Expansion screw X 2



Cross recessed screw X 1
Ring terminal X 1

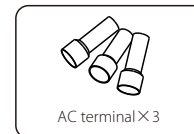

AC terminal X 3

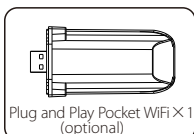

Plug and Play Pocket WiFi X 1
(optional)



Product manual X 1



Quick installation guide X 1

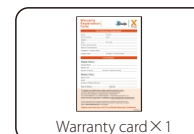

Warranty card X 1

III

PV Connection

Cable size: 12 AWG
trip length:

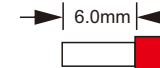

-Align the two halves connectors.

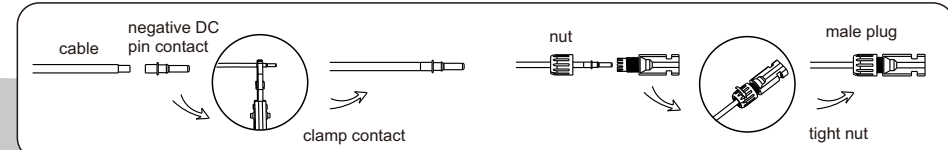
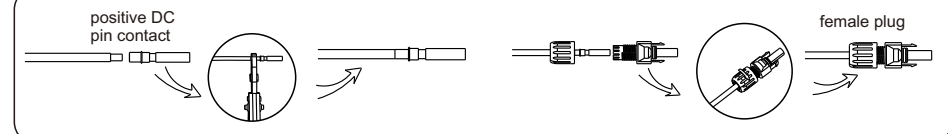
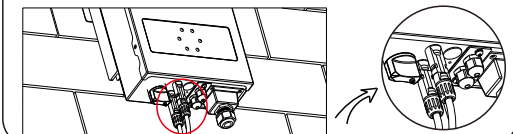

IV

AC Connection

Cable size: 10 AWG

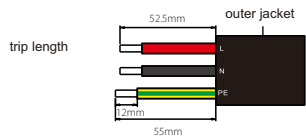

- Open AC lid

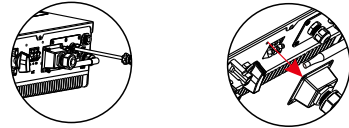

AC terminal



clamp contact

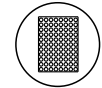

cable core section

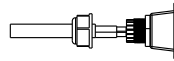

through AC lid

- Insert the terminals into the corresponding holes and fasten them.

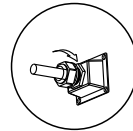
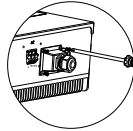
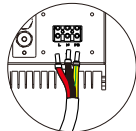
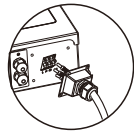

V

WiFi Connection(optional)

- Open the WiFi lid on the bottom of the inverter.

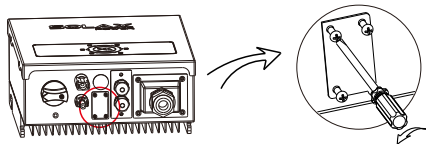

- Plug the Pocket WiFi (from Solax) into the port named "WiFi" on inverter, and tighten the four screws as below.

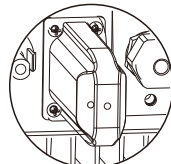
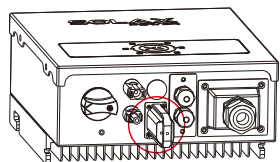
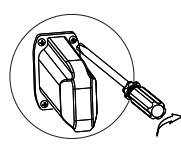

VI

Usb for Updating

- Open the communication lid on the bottom of the inverter as below.

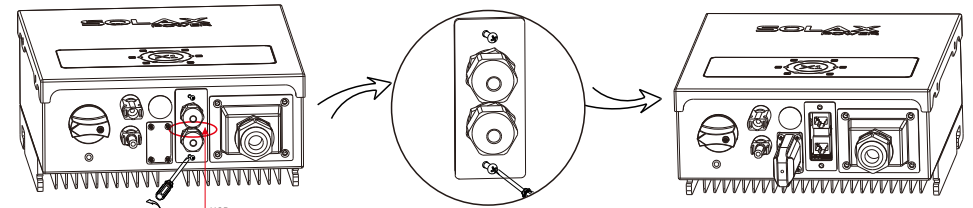

- Insert the USB flash drive with program into the "USB" port on the bottom.

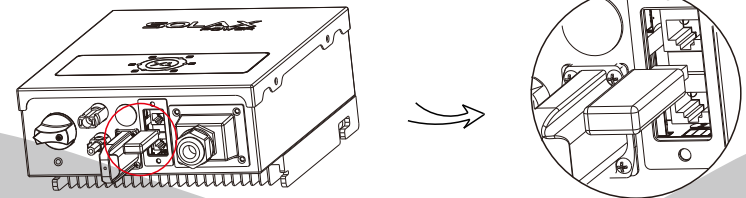

VII

Overview for Connection



Warning!

Be sure this ground wire must be connected !

- Screw the ground screw with allen wrench shown as follow.

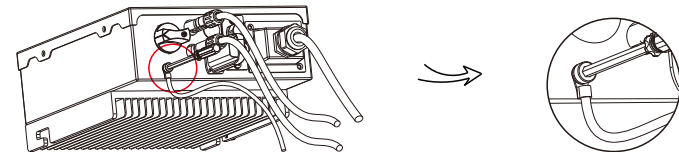

- Overview for connection.

